

Modular Lab Series

Healthcare | [Laboratory](#) | Transportation



SYSTEM2

*"Bespoke, Highly Quality, modular and flexible solutions
for the healthcare and laboratory industry."*



healthcare
laboratory
transportation

our
team



designed, developed, and proudly
made in Singapore

SYSTMZ

LABORATORY FURNITURE SPECIALIST

Systmz - Singapore's Leading Design & Build Laboratory Furniture Specialist.

modularity

We research, design, manufacture and market highly modular and flexible products for the Healthcare, Laboratory, and Transportation market.

customisation

Our team of award winning industrial designers, mechanical engineers, and product specialist work hand in hand with our customers to develop customised products to meet specific needs.

integration

Systmz products are fully manufactured in-house (woodwork, plasticwork & metalwork) in Singapore.

We are able to integrate electrical and gas systems efficiently

Good design, high quality materials, and precision manufacturing ensures

Systmz products are best in class.

Our Customers

- Abbott ■ Baxter ■ Cerebos ■ Firmenich ■ Fortis Surgical Hospital ■ Cycle & Carriage
- Health Science Authority ■ Jurong Health ■ Khoo Teck Puat Hospital ■ Mount Elizabeth Hospital
- Nanyang Polytechnic ■ National University of Singapore ■ National University Hospital ■ P&G
- Panasonic ■ Singapore National Eye Centre ■ St Lukes Hospital ■ Tan Tock Seng Hospital
- Thye Hua Kwan Hospital ■ TÜV ■ Wyeth

About Us 5

Selection Process 6

Overview 7

LT Series 8

HD Series 12

FX Series 16

SV Storage 20

MT - 01 22

CF Series 24

Specifications 30

SELECTION PROCESS

STEP 1

Frame Structure

- LT Series
- HD Series
- FX Series

STEP 2

Bench Worktop

- Epoxy
- Phenolic
- Solid Plywood
- Stainless Steel

STEP 3

Overbench Storage

- Upright Hanging Cabinets
- Upright Lower Shelving
- Upright Upper Shelving

STEP 4

Underbench Storage

- Floorstanding Cabinet
- Mobile Cabinet
- Sliding Cabinet

STEP 5

Service Fixture

- Service Valve
- Service Hose
- Water Fitting
- Eye Wash

STEP 6

Electrical Fixture

- Power & Data Outlets
- Powertrack System
- DADO Trunking System

STEP 7

Accessories

- LED Task Light
- LED Strip Light

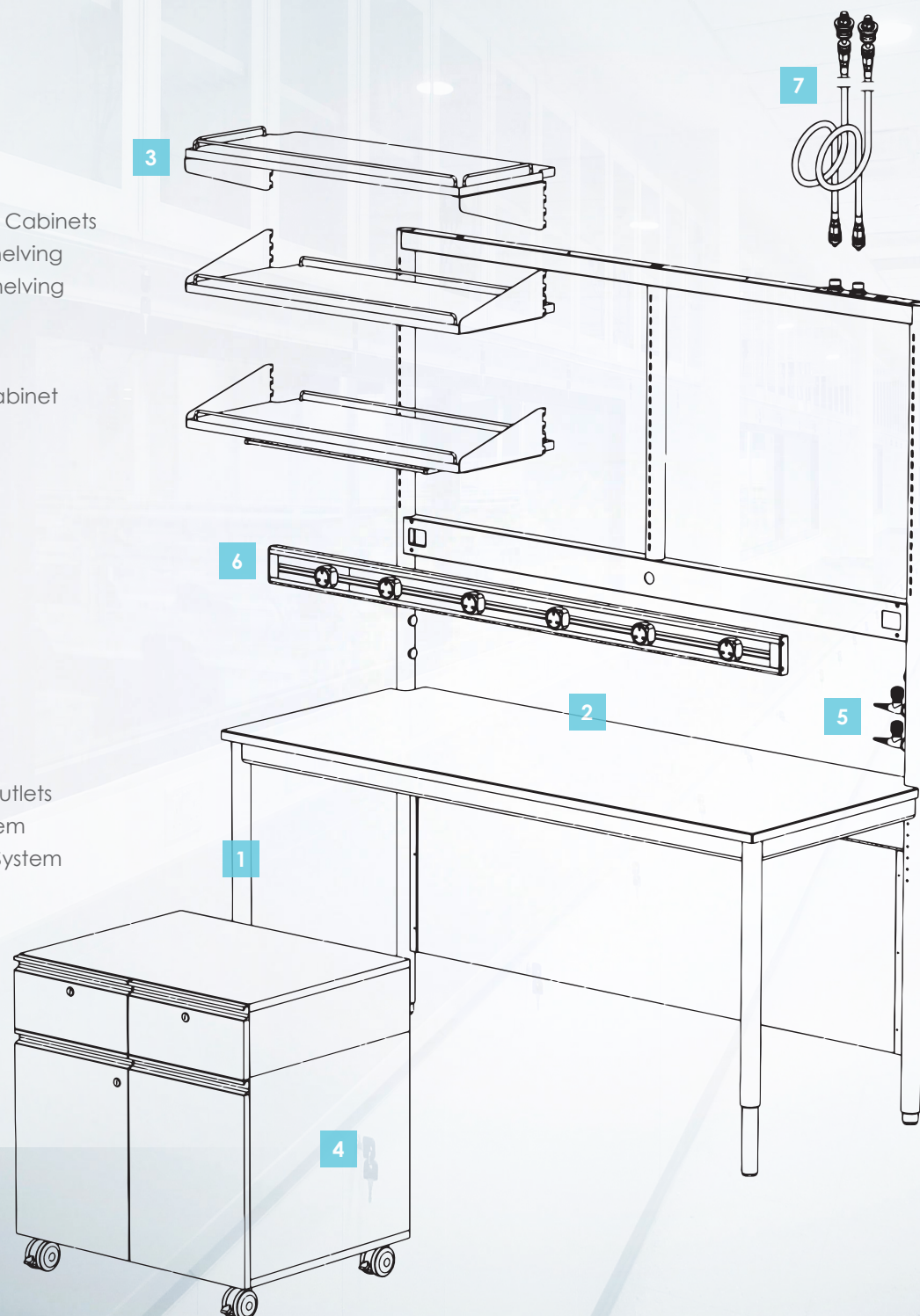

Systemz - Laboratory Furniture

Since our first successful introduction of aluminium lab furniture in 2009, we have installed more than **50000m² of lab space with over 4000 users**. Our range of aluminium profiles have grown to more than 100 designs to allow endless design possibilities. The aluminium Lab Furniture range largely falls into 3 types: **LT Series, HD Series and FX series**.

Each of these types serve a unique design criterion and are further customisable to suit the needs of users.

Systemz is the leading customise laboratory solutions provider. Our dynamic in-house

design, prototyping, manufacturing and installation teams are renown for delivering innovative and high quality products within limited timeline. By extending our modular design philosophy to manufacturing, we retain the greatest possible freedom to meet customer's specifications.

Simulation tests are carried out before production using **FEA** tools in the design phase to ensure our products meet stringent standards.

Products are subjected to a thorough 100% inspection before delivery.

LT, HD, FX Series are ideal for:

- Modular lab design requirements
- Highly flexible and re-configurable
- All types of laboratories, such as teaching, research, chemical, analytical physical laboratories
- Lab furniture with fully integrated service of power, data, lighting and gas services
- Customized Size, Function and Finishes
- Short delivery lead time and rapid on-site installation
- Harsh work environment, Anti-Corrosion Structure - Full Aluminium with High load ratings
- Mobile Benches, Balance Table, Microscopy table, Anti-Vibration table

Our products are available as standard in:

- Aluminium Structure - Anodised, PVDF (fluorocarbon), or Epoxy coated, any color
- Casework - Timber, Metal, Phenolic or combinations - Modular design and construction
- Materials with different chemical resistance

LT SERIES



*Integrated in-house
production ensures
tight control over
manufacturing
quality and lead time*



Telescopic Legs



Future proof details



Quick connect



Seamless features

LT SERIES



LT Series

- Highly mobile
- Height adjustable
- Installed in over 3000 stations
- Extensively used in over more than 500,000ft²
- Load rating 250kg/m²

Recommended for

- Teaching labs & schools

Projects

National University of Singapore / Tan Tock Seng Hospital / Singapore General Hospital

1. Integrated quick connect gas & power system - reconfiguration ready
2. Customised power track system & LED fittings
3. Colour accent - lively work environment
4. Customise full height glass storage systems
5. Maximise workspace
6. FEA analysis

HD SERIES



Our design team will explore every possible scenario and deliver break-through solutions

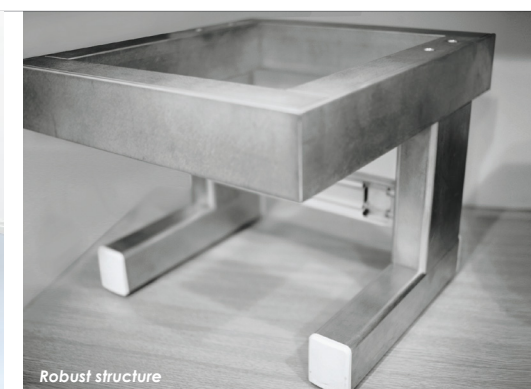

Robust structure



Integrated services



Integrated services



Integrated services

HD SERIES



HD Series

- Fully concealed fasteners
- Clean unibody appearance
- Super rigid structure
- Ultra high load rating - 450kg/m²

Recommended for

- Balance table
- Microscopy table

Projects

American Multinational Consumer Goods Company

1. Aesthetic end caps with telescopic gap free feature
2. Unibody appearance (concealed fasteners)
3. FEA analysis

FX SERIES

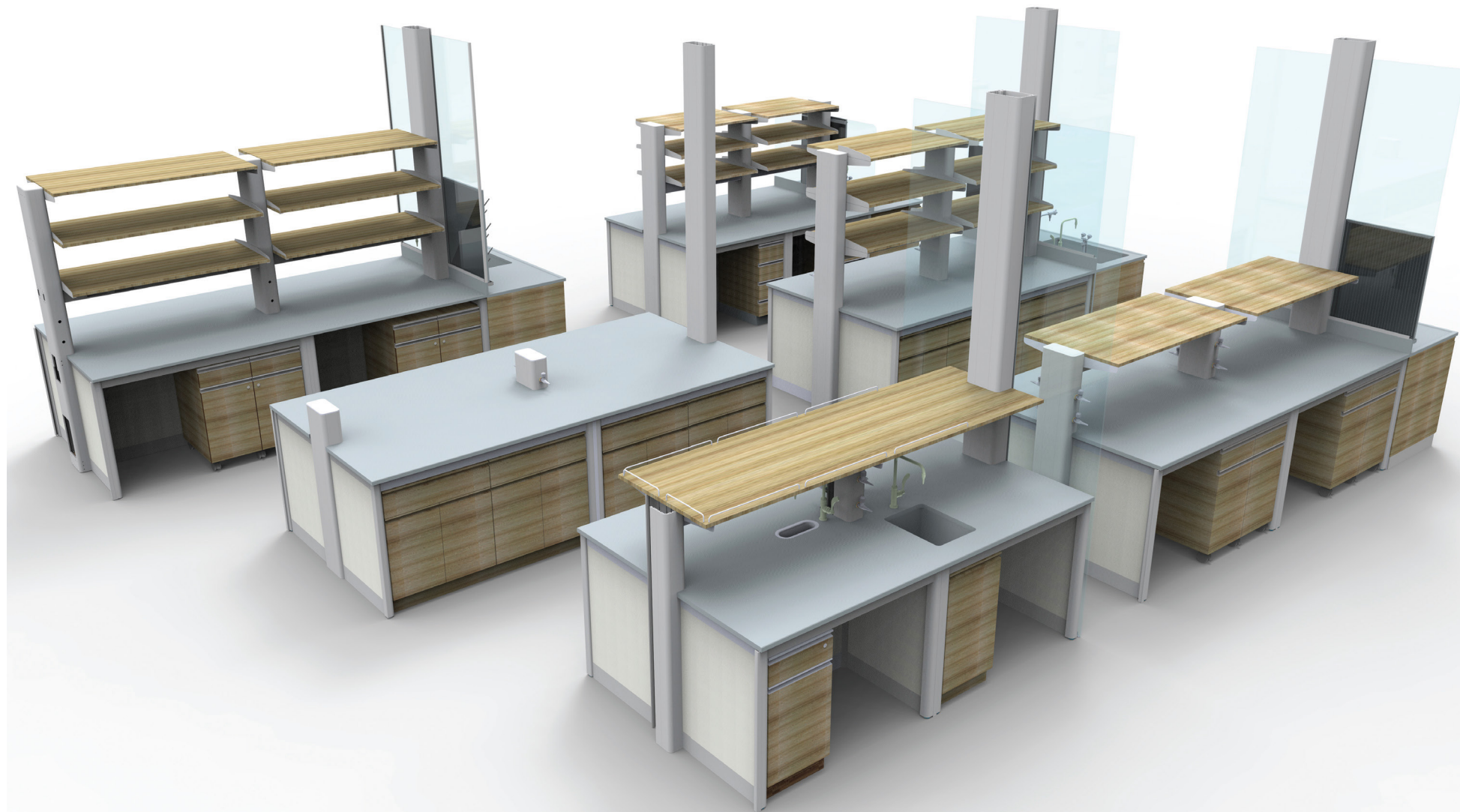

Modular design,
our belief,
our passion,
limitless



Attention to detail

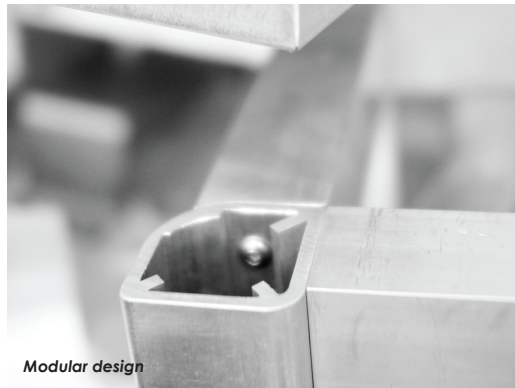

Modular design



Durable accessories

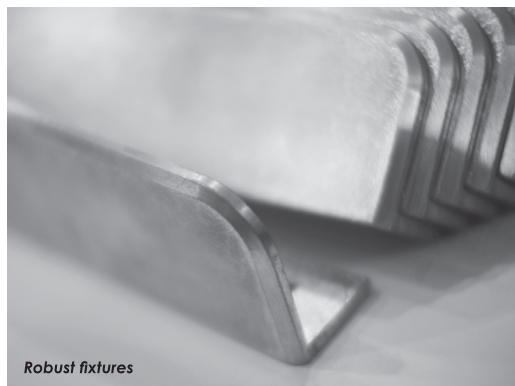

Robust fixtures

FX SERIES

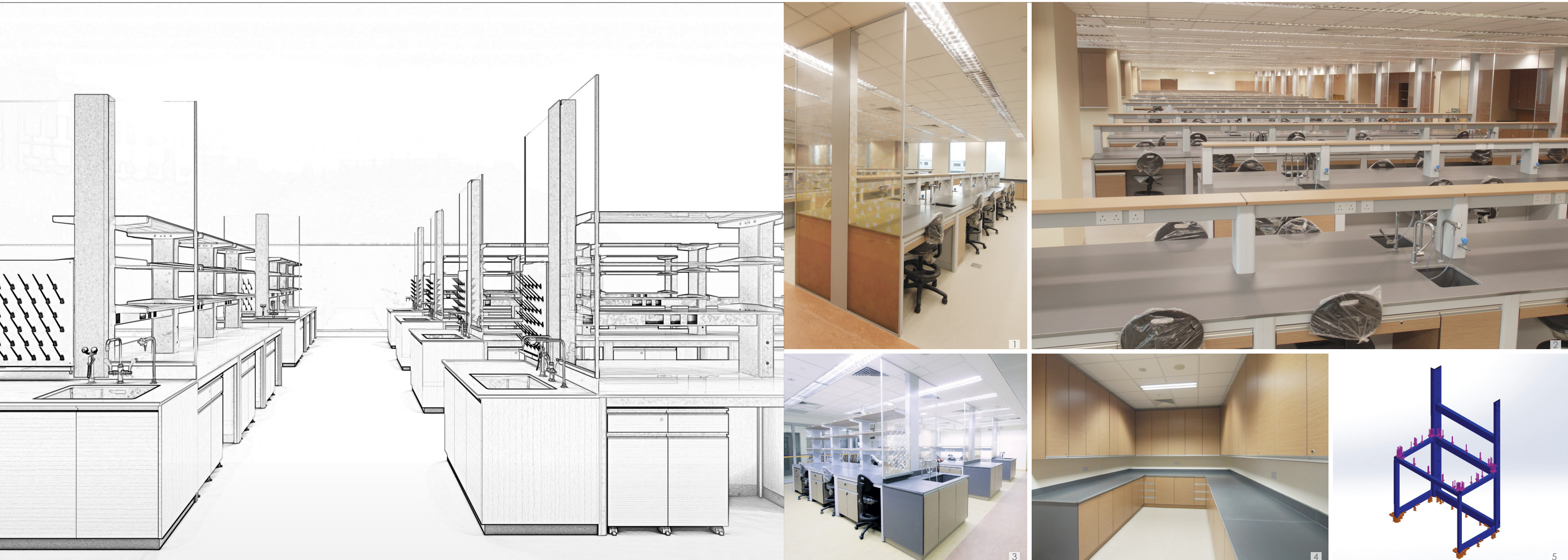

FX Series

- Seamless outlook design
- limitless combinations
- Dedicated horizontal service duct
- Integrated vertical service chase column

Recommended for

- One system (multi permutations)

Projects

National University of Singapore

1. Customised intergrated 2. High quality installation 3. Seamless design - integrated height leveler 4. CNC shelving supports - attention to detail 5. FEA analysis

SV STORAGE



SV Storage

- Stainless steel
- Aluminium
- Phenolic
- Laminated plywood

Recommended for

- High loading requirements

1. Attention to detail 2. Future proof detail 3. Modular design 4. Attention to detail
5. Universal design 6. FEA analysis

MT-01 TRUNKING



MT-01 Trunking

- Full concealed fastener
- Clean unibody appearance
- Prefabricated fpr quick installation
- Modular design for future modification
- Full aluminium chasiss

Projects

Singapore University of Technology and Design

1. Accommodating configuration 2. Seamless construction 3. Hidden feature for quick installation
4. High quality finishing 5.Attention to detail 6. Technical drawing

CF SERIES

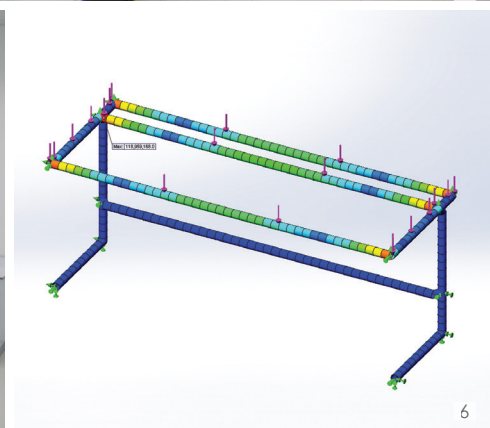

CF Series

- Easy to clean & maintain laboratories
- Flexibility of using various cabinet/drawers
- Complete knock down capabilities

Projects

Abbott / Wyeth / Cerebos / Baxter / Nanyang Polytechnic /
Khoo Teck Puat Hospital / Health Science Authority

1. & 2. Attention to detail 3., 4. & 5. Seamless design 6. FEA analysis

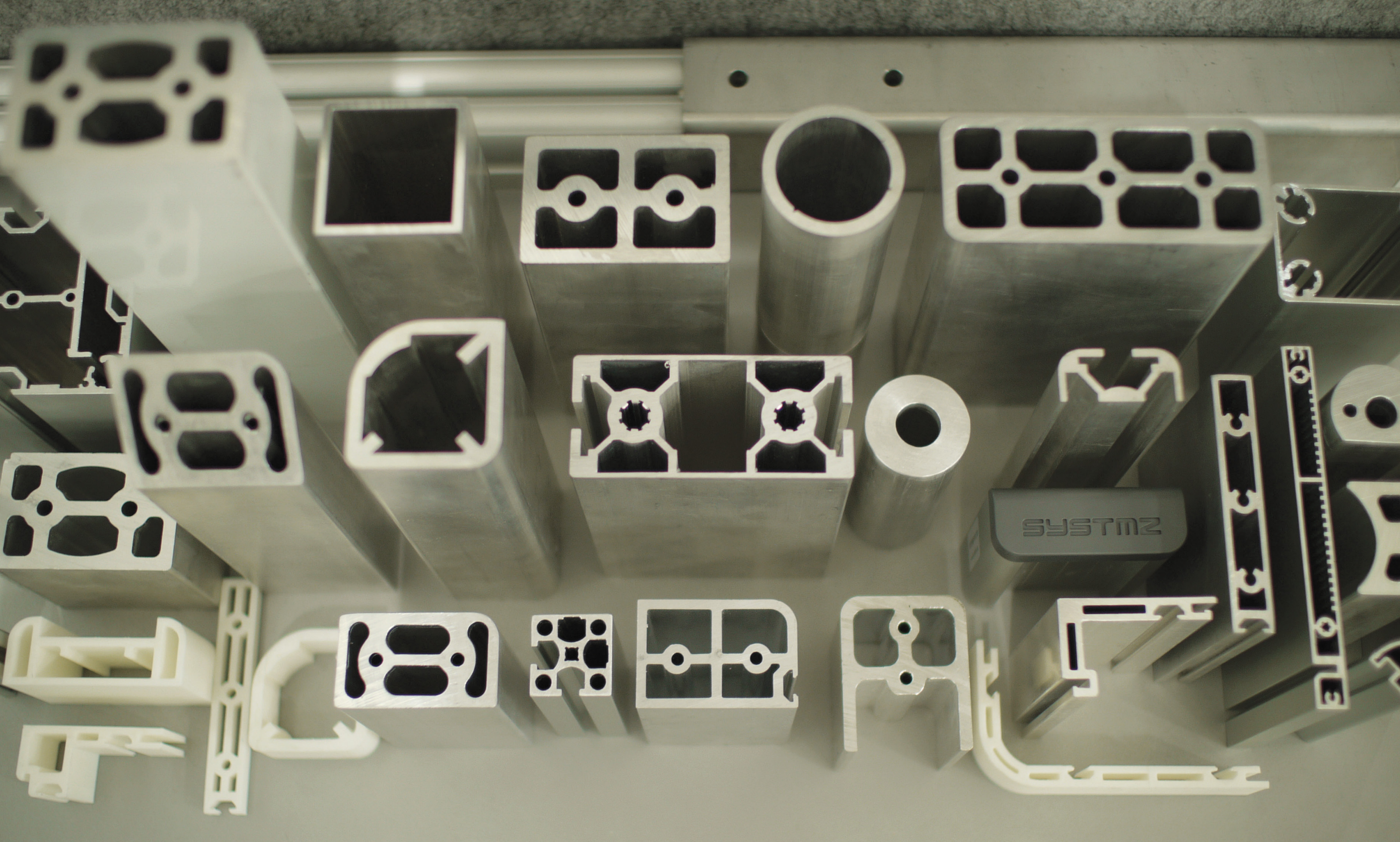

Customised Profile & Parts
Over 100 designs

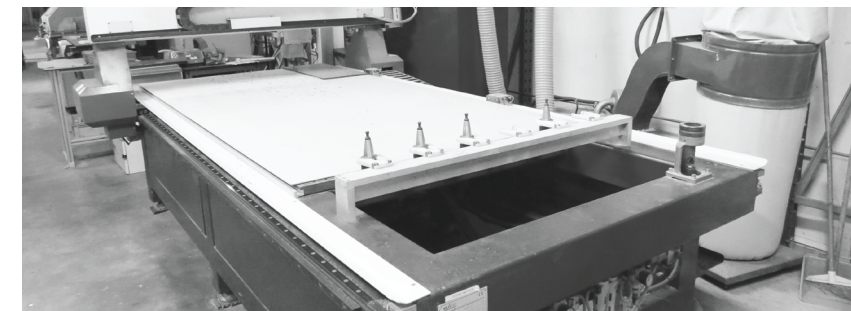
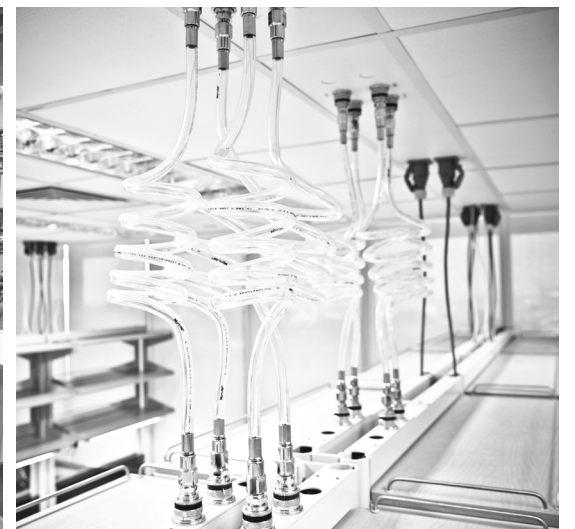
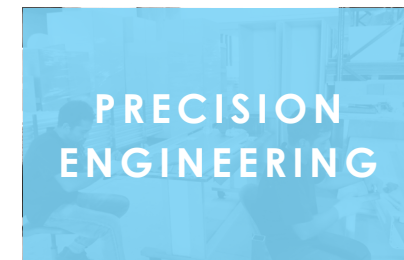
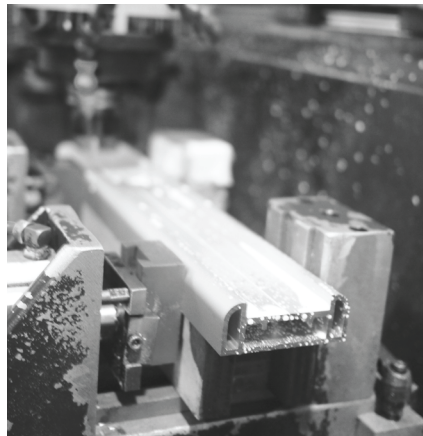
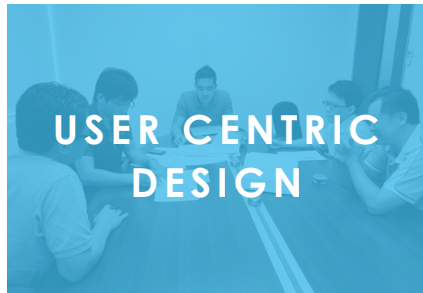
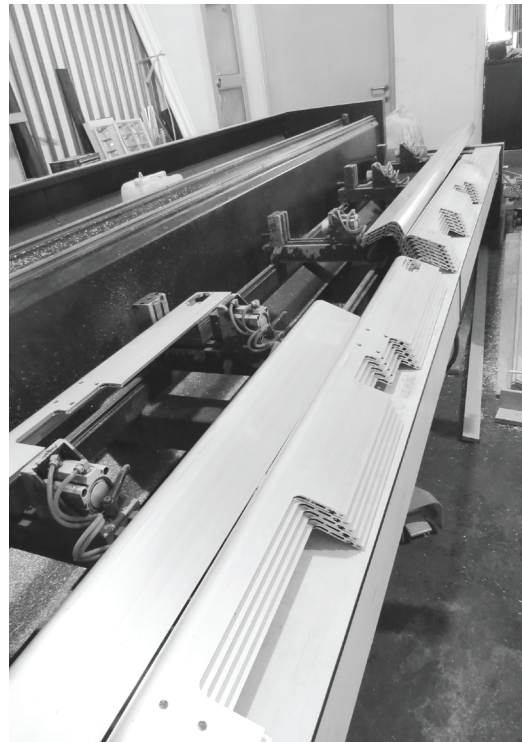

SPECIFICATIONS

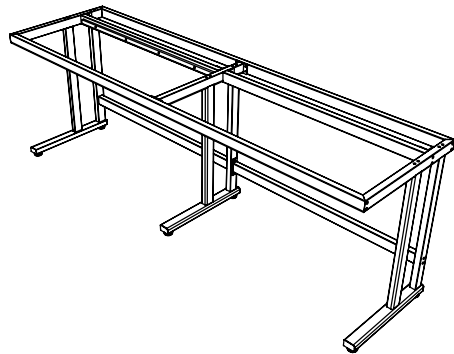
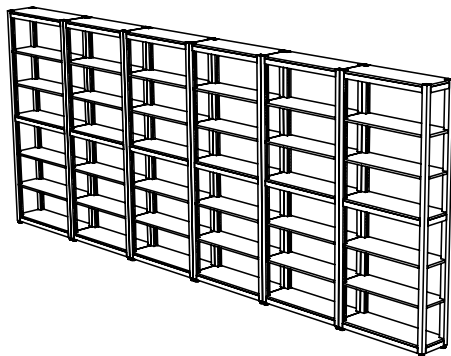
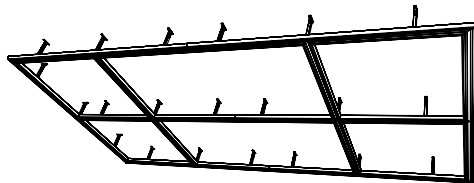
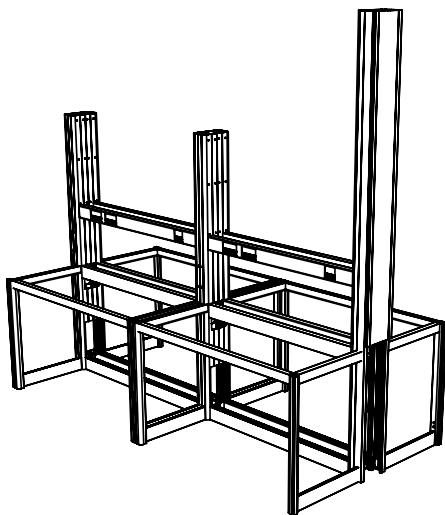
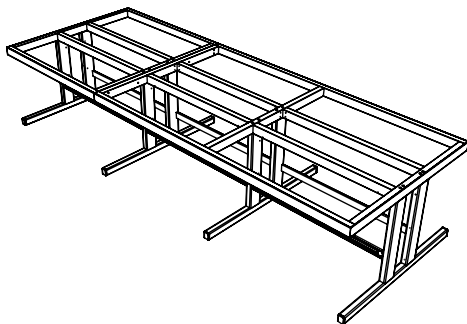
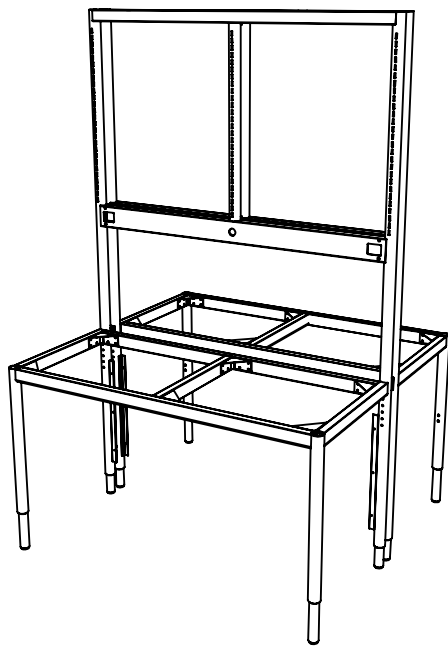

LT SERIES

Overall Dimension:
1000~1800L/600~900D/1800~2300H (mm)
Load Rating: 250kg/m²
Material: Aluminium
Warranty: As Per Contract (1~3years)
Modularity: *****
Height Adjustability: *****
Seamlessness: ****
Storage/Placement Option:
• Laminated Shelving (1-tier/2-tier/3-tier)
• Top Hang Cabinet 600H/900H(mm)
• Open Cabinet 600H/900H(mm)
• Mixture
• Mobile Pedestal
Power Source Option:
• Eubiq Track
• Sockets Outlets
Power Source to Outlet:
Service Pannel Form Ceiling with CEE foam to outlet
Worktop Option
• Epoxy Resin
• Phenolic Resin
• Chemical Resistant Laminated Marine Plywood
Gas Source Option:
• Desk Mounted
• Frame Mounted

HD SERIES

Overall Dimension:
1000~2400L/600~900D/900H (mm)
Load Rating: 450kg/m²
Material: Aluminium
Warranty: As Per Contract (1~3years)
Modularity: ***
Height Adjustability: ***
Seamlessness: *****
Storage/Placement Option:
• Underbench Suspended Cabinet
• Mobile Pedestal
Power Source Option:
• Eubiq Track
• Sockets Outlets
Power Source to Outlet:
Service Pannel Form Ceiling with CEE foam to outlet
Worktop Option
• Epoxy Resin
• Phenolic Resin
• Chemical Resistant Laminated Marine Plywood
Gas Source Option:
• Desk Mounted
• Frame Mounted

FX SERIES

Overall Dimension:
1000~1800L/600~900D/1800~2300H (mm)
Load Rating: 350kg/m²
Material: Aluminium
Warranty: As Per Contract (1~3years)
Modularity: ***
Height Adjustability: **
Seamlessness: ****
Storage/Placement Option:
• Laminated Shelving (1-tier/2-tier/3-tier)
• Underbench Suspended Cabinet
• Underbench Based Cabinet
• Mobile Pedestal
Power Source Option:
• Eubiq Track
• Sockets Outlets
Power Source to Outlet:
Service Pannel F Ceiling with CEE foam to outlet
Worktop Option
• Epoxy Resin
• Phenolic Resin
• Chemical Resistant Laminated Marine Plywood
Gas Source Option:
• Desk Mounted
• Frame Mounted

MT01 TRUNKING

Overall Dimension:
1000~1800L/600~900D/1800~2300H (mm)
Load Rating: 250kg/m²
Material: Aluminium
Modularity: ***
Seamlessness: *****
Power Source Option:
• Eubiq Track
• Sockets Outlets
Power Source to Outlet:
Service Pannel Form Ceiling with CEE foam to outlet

SV STORAGE

Overall Dimension:
400~1000L/400~600D/1800~2100H (mm)
Load Rating: 100kg/m²
Material: SS Steel / Aluminium
Warranty: As Per Contract (1~3years)
Modularity: ****
Height Adjustability: *****
Seamlessness: ***
Shelf's Material Option:
• Laminated Plywood
• Stainless Steel Shelving
Stainless Steel Finishes:
SS 316 Hairline Finish

CF SERIES

Overall Dimension:
1000~1500L/600~750D/250~900H (mm)
Load Rating: 250kg/m²
Material: Aluminium
Warranty: As Per Contract (1~3years)
Modularity: ****
Height Adjustability: ***
Seamlessness: **
Worktop Option:
• Epoxy Resin
• Phenolic Resin
• Chemical Resistant Laminated Marine Plywood
Storage Option:
• Underbench Suspended Cabinet
• Mobile Pedestal



Singapore (HQ)

Systmz Pte Ltd
16 Sungei Kadut Way
Singapore 728793
Tel: +65 6465 0387 Fax: +65 6465 0656
Email: info@systmz.sg Website: www.systmz.sg

Malaysia (Office)

Systmz Sdn Bhd
No.11, Jalan PJU 3/46,
Sunway Damansara Technology Park,
47810 Petaling Jaya,
Selangor Darul Ehsan, Malaysia.
Tel: +603 7803 8088 Fax: +603 7803 8211
Email: info@systmz.com.my Website: www.systmz.com.my

Dubai (Liaison Office)

Al Leddan General Trading
P.O. Box 488176
Dubai - UAE, Barsha
Dusseldorf Business Tower - 402
Tel: +971 4 4570375
Mobile: +971 50 2323001
Email: info@systmz.sg

www.systmz.sg



V1
10/2016

